

ANTI-SIPHON FORST PROOF SILLCOCK

- **With Integral Vacuum Breaker**
- **Chrome Plated Body**
- **125 PSI**



NOMENCLATURE AND MATERIALS

NO.	PART	MATERIAL	SPEC.JIS	SPEC.ASTM	NO.	PART	MATERIAL	SPEC.JIS	SPEC.ASTM
1	HANDLE SCREW	BRASS	C2700W	B134-C27000	9-3	SPRING	STAINLESS	SUS304	304STAINLESS
2	NAME PLATE	ALUMINUM	A100P	B209-1100	9-4	DISC	BRASS	C3604B	B16-C36000
3	HAND WHEEL	ZINE ALLOY	H5301	B86	9-5	O-RING	RUBBER	NBR	BUNA-N
		PLASTIC	ABS	ABS	9-6	DIAPHRAGM	RUBBER	NBR	NBR
4	STEM GLAND SCREW	BRASS	C3604B	B16-C36000	9-7	PACKING HOLDER	BRASS	C3604B	B16-C36000
5	WASHER	STAINLESS	SUS304	304STAINLESS	9-8	SEAT PACKING	RUBBER	NBR	BUNA-N
5-1	STEM PACKING	RUBBER	NBR	BUNA-N	9-9	PACKING SCREW	BRASS	C2700W	B134-C27000
6	STOP WASHER	STAINLESS	SUS304	304STAINLESS	10	VB COVER	PLASTIC	PP	PP
7	BODY	CAST BRASS	YBSC3	B584-C85700	11	VB BODY	PLASTIC	CELCON	CELCON
8-1	ED SEAT	CAST BRASS	YBSC3	B584-C85700	12-1	VB DISC	PLASTIC	CELCON	CELCON
8-2	T SEAT	CAST BRASS	YBSC3	B584-C85700	12-2	VB PACKING	RUBBER	NBR	BUNA-N
8-3	TUBE	BRASS	C2600T	B135-C26000	13	SIDING SEDGE	PLASTIC	NYLON	NYLON
9-1	STEM	BRASS	C2600T	B135-C26000	14	VB O-RING	RUBBER	NBR	BUNA-N
9-2	PISTON	BRASS	C3604B	B16-C36000					

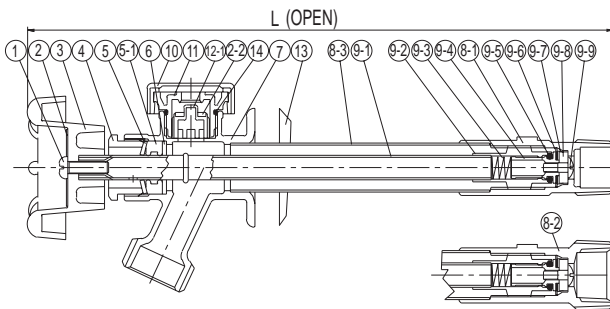

DIMENSIONS-QUANTITIES / F2264 & F2264A			
NOMINAL SIZE	L(OPEN)	PCS	
		Carton	Case
4"	235	40	/
6"	286	40	/
8"	337	40	/
10"	388	40	/
12"	439	40	/
14"	490	40	/



FIG:F2264
(1/2"Cx1/2"M INLET)



FIG:F2264A
(1/2"Fx3/4"M INLET)