

# FORGED BRASS GAS BALL VALVE

• **Blow-out Proof Stem**      • **With Pilot Tap**



## NOMENCLATURE AND MATERIALS

| NO. | PART             | MATERIAL  | SPEC.JIS | SPEC.ASTM  | NO. | PART              | MATERIAL     | SPEC.JIS   | SPEC.ASTM   |
|-----|------------------|-----------|----------|------------|-----|-------------------|--------------|------------|-------------|
| 1   | SCREW            | STEEL     | S10C     | AISI-1010  | 7   | BODY              | FORGED BRASS | C3771B     | B124-C37700 |
| 2   | HAND             | ZINCALLOY | H5301    | B86        | 8   | BALL DISC PACKING | TEFLON       | PTFE       | PTFE        |
| 3   | STEM             | BRASS     | C3604B   | B16-C36000 | 9   | BALL DISC         | BRASS        | C3604B     | B16-C36000  |
| 4   | STEM GLAND SCREW | BRASS     | C3604B   | B16-C36000 | 10  | END PLUG          | FORGED BRASS | C3771B     | B124-C37700 |
| 5   | GLAND PACKING    | TEFLON    | PTFE     | PTFE       | 11  | THREAD COVER      | PLASTIC      | COMMERCIAL | COMMERCIAL  |
| 6   | NAME PLATE       | ALUMINUM  | A1100P   | B209-1100  | 12  | PLUG              | BRASS        | C3604B     | B16-C36000  |

### • Female x Female



FIG:F1361GTL

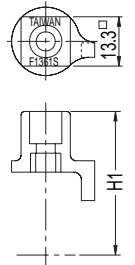
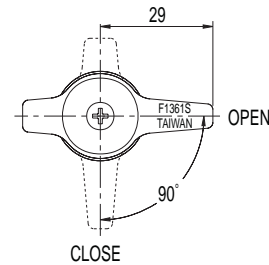
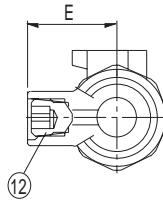
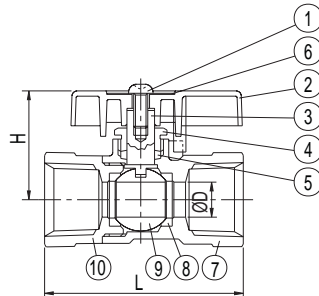

FIG: F1361GTL  
F1361GFTL  
F1361FFTL

FIG: F1361GTS  
F1361GFTS  
F1361FFTS

### • Female x Flare



FIG:F1361GFTL

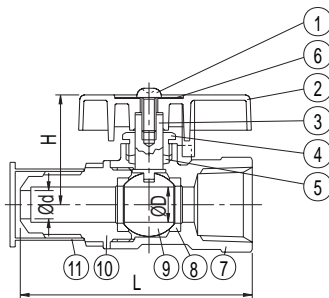

### • Flare x Flare

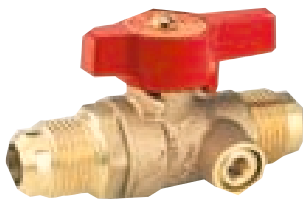
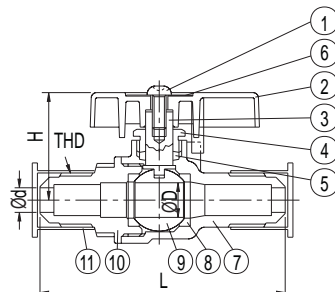

FIG:F1361FFTL



#### DIMENSIONS-QUANTITIES

| FIG NO :               | NOMINAL SIZE             | DIMENSION (mm) |    |    |      |    |    | PCS    |      |
|------------------------|--------------------------|----------------|----|----|------|----|----|--------|------|
|                        |                          | L              | H  | D  | d    | E  | HI | Carton | Case |
| F1361GTL               | 1/2"                     | 57             | 31 | 10 | /    | 23 | 37 | 120    | /    |
| F1361GTS               | 3/4"                     | 65             | 35 | 15 | /    | 25 | 41 | 120    | /    |
| F1361GFTL<br>F1361GFTS | 1/2"X3/8"<br>(9/16"-24)  | 64             | 31 | 10 | 7    | 23 | 37 | 120    | /    |
|                        | 1/2"X3/8"<br>(5/8"-18)   | 64             | 31 | 10 | 7    | 23 | 37 | 120    | /    |
|                        | 1/2"X1/2"<br>(3/4"-16)   | 66             | 31 | 10 | 10   | 23 | 37 | 120    | /    |
|                        | 1/2"X5/8"<br>(15/16"-16) | 72             | 31 | 10 | 12.7 | 23 | 37 | 120    | /    |
| F1361FFTL<br>F1361FFTS | 3/4"X5/8"<br>(15/16"-16) | 79             | 35 | 15 | 12.7 | 25 | 41 | 120    | /    |
|                        | 3/8"X3/8"<br>(5/8"-18)   | 71             | 31 | 10 | 7    | 20 | 37 | 120    | /    |
|                        | 1/2"X1/2"<br>(3/4"-16)   | 74             | 31 | 10 | 10   | 20 | 37 | 120    | /    |