

# FORGED BRASS GAS BALL VALVE

• **Blow-out Proof Stem**



MH15973  
Listed  
2J73

## NOMENCLATURE AND MATERIALS

NO.	PART	MATERIAL	SPEC.JIS	SPEC.ASTM	NO.	PART	MATERIAL	SPEC.JIS	SPEC.ASTM
1	SCREW	STEEL	S10C	AISI-1010	7	BODY	FORGED BRASS	C3771B	B124-C37700
2	HANDLE	ZINC ALLOY	H5301	B86	8	BALL DISC PACKING	TEFLON	PTFE	PTFE
3	STEM	BRASS	C3604B	B16-C36000	9	BALL DISC	BRASS	C3604B	B16-C36000
4	STEM GLAND SCREW	BRASS	C3604B	B16-C36000	10	END PLUG	FORGED BRASS	C3771B	B124-C37700
5	GLAND PACKING	TEFLON	PTFE	PTFE	11	THREAD COVER	PLASTIC	COMMERCIAL	COMMERCIAL
6	NAME PLATE	ALUMINUM	A1100P	B209-1100					

### • Female x Female



FIG:F1361SPMCL

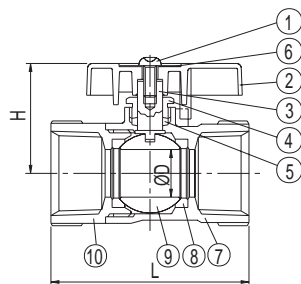

### • Female x Flare



FIG:F1361GFCL

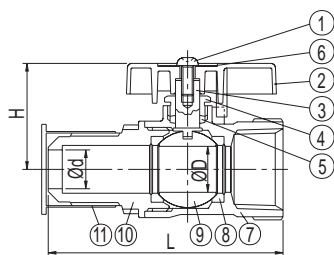

### • Flare x Flare



FIG:F1361FFCL

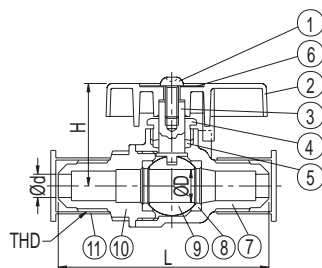

### DIMENSIONS-QUANTITIES

FIG NO:	NOMINAL SIZE	DIMENSION (mm)							PCS	
		L	H	D	d	H1	L1	L2	Carton	Case
F1361SPMCL F1361SPMCS	3/8"	46	31	10	/	37	29	13.3	144	288
	1/2"	55	31	10	/	37	29	13.3	144	288
	3/4"	62	35	15	/	41	29	13.3	144	288
	1"	73	42	20	/	48	40	17	60	180
F1361GFCL F1361GFCS	-1A 1/2"X3/8" (9/16"-24)	62	31	10	7	37	29	13.3	144	288
	-1B 1/2"X3/8" (5/8-18)	62	31	10	7	37	29	13.3	144	288
	-2 1/2"X1/2" (3/4"-16)	64	31	10	10	37	29	13.3	144	288
	-3 3/4"X5/8" (15/16"-16)	77	35	15	12.7	41	29	13.3	144	288
	-4 1/2"X5/8" (15/16"-16)	72	31	10	12.7	37	29	13.3	144	288
(Angle) -5 3/4"X5/8" (15/16"-16)	46	35	14	12.7	41	29	13.3	144	288	
F1361FFCL F1361FFCS	3/8"X3/8" (5/8"-18)	64	31	10	7	37	29	13.3	144	288
	1/2"X1/2" (3/4"-16)	67	31	10	10	37	29	13.3	144	288

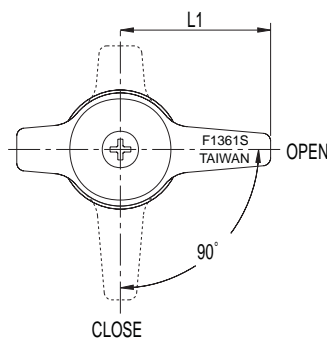

FIG: F1361SPMCL  
F1361GFCL  
F1361FFCL

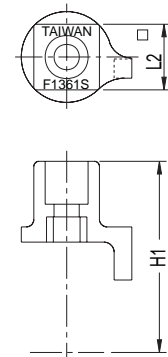

FIG: F1361SPMCS  
F1361GFCS  
F1361FFCS