

FULL PORT FORGED BRASS BALL VALVE

- 600 W.O.G. : 1/2"~1 1/2"
- 400 W.O.G. : 2"~3"
- 150 PSI Saturated Steam
- Blow-out Proof Stem
- Screwed Ends & CxC
- Conforms to MSS SP-110

NOMENCLATURE AND MATERIALS

NO.	PART	MATERIAL	SPEC.JIS	SPEC.ASTM	NO.	PART	MATERIAL	SPEC.JIS	SPEC.ASTM
1	NUT	STEEL	S10C	AISI-1010	6	BODY	FORGED BRASS	C3771B	B124-C37700 (1/2"-1")
2	HANDLE	STEEL	SS41	A283-D			CAST BRASS	YBSC3	B584-C85700 (1 1/4"-3")
3	WASHER	TEFLON	PTFE	PTFE	7	BALL DISC PACKING	TEFLON	PTFE	PTFE
4	O-RING	RUBBER	NBR	NBR	8	BALL DISC	BRASS	C3604B	B16-C36000 (1/2"-3/4")
5	STEM	BRASS	C3604B	B16-C36000			FORGED BRASS	C3771B	B124-C37700 (1"-3")
					9	END PLUG	FORGED BRASS	C3771B	B124-C37700

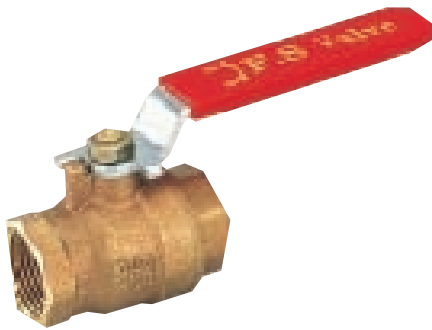
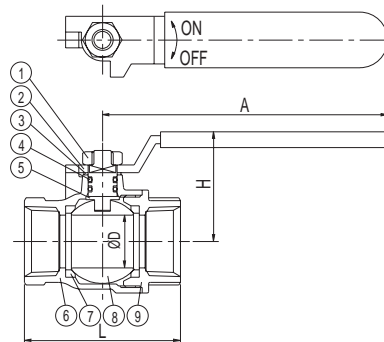

FIG:F1161FP



DIMENSIONS-QUANTITIES /F1161FP & F1162FP

NOMINAL SIZE	DIMENSION (mm)					PCS	
	L	L1	H	D	A	Carton	Case
1/2"	48	49	34	12.7	75	120	400
3/4"	59	70	42	20	108	90	200
1"	67	84	45	25	108	60	144
1 1/4"	81	96	55	32	122	36	80
1 1/2"	90	109	59	38	122	24	64
2"	106	137	72	50	185	12	30
2 1/2"	130	158	83	63	185	8	24
3"	149	182	103	75	250	6	20



FIG:F1162FP

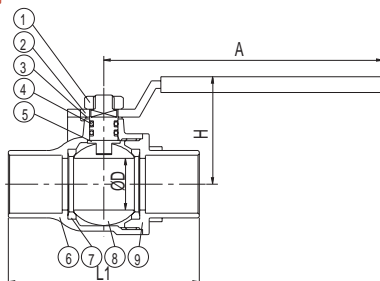

PRESSURE/TEMPERATURE RATING

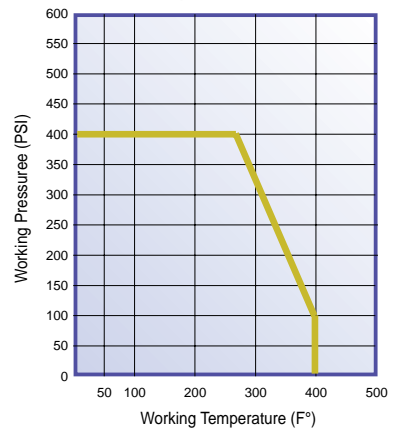

* F1161FP, F1162FP: 2"-3" only